

# AlphaRelief

## Quick Reference Guide

(For more detailed instructions, refer to the User Manual)

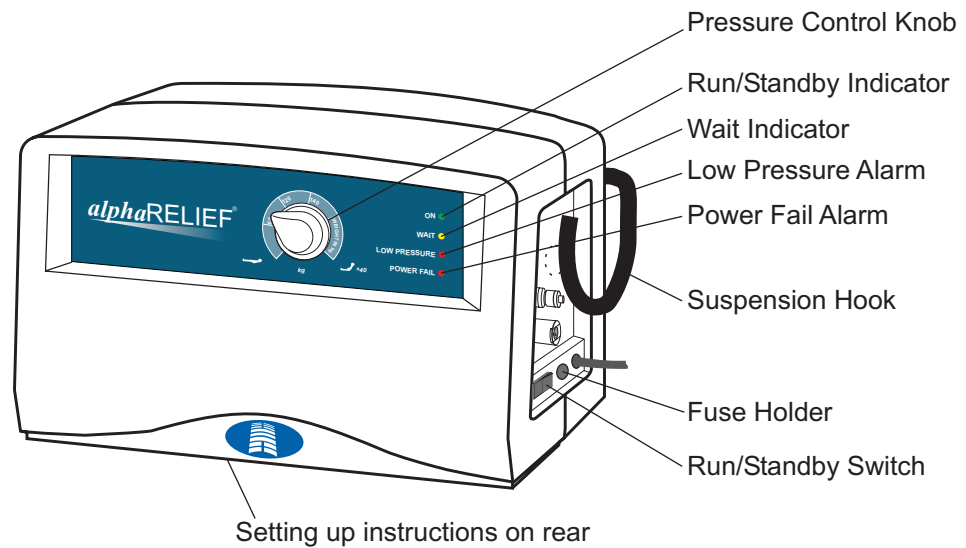

### Run Standby Switch/ Alarm Reset

Switches the pump on and off. An internal battery will activate an audible and visual alarm if the power supply is interrupted prior to switching off. Examples are mains lead removal and power failure. Once an alarm condition has been resolved, the pump can be reset by switching the pump to standby and back to run again using the **Run/Standby** switch on the side panel.



### On

The green **On** indicator is illuminated on the front panel when the pump is running.



### Wait

The yellow **Wait** indicator is illuminated when the mattress is being inflated. The indicator will remain illuminated until the mattress has been fully inflated.



### Low Pressure

The red **Low Pressure** indicator will flash whenever the pump detects low pressure within the mattress. An audible alarm will sound. The indicator will extinguish once normal pressure is reached. Check CPR stopper at the head end is securely inserted and the tubeset is connected properly.



### Power Fail

The red **Power Fail** alarm indicator will start flashing when a mains power failure has been detected by the pump. An audible alarm will sound until power is resumed or the pump is switched off using the run/standby switch.



### Manual Pressure Adjustment

The mattress cell pressure can be manually adjusted for individual patient weights using the dial on the pump face. Ensure that the patient is not bottoming out by unfastening one side of the **AlphaRelief** MR and sliding a hand underneath the cells. If you can freely put a flat hand under the patient the mattress is inflated correctly.

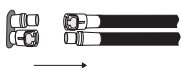

### Transport Mode

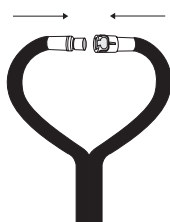

The patient may be transported on the **Alpha Relief** MR by disconnecting the tubes from the pump and cross connecting them immediately. The pressure in the cells will equalise and the patient will be supported for up to 8 eight hours with the patient in the supine position.

*For optimum use of the Transport facility set the mattress to Transport mode when all cells are inflated at cell cross over. Ensure that the patient remains in the supine position.*

## Installation

### Alpha Relief Mattress Replacement (MR)

Place the MR directly onto the bed base, with the tubeset located near the foot end of the bed and the CPR stopper at the head end. The cells of the mattress must be uppermost.

Use the straps provided to ensure that the MR is secured to the moving parts of the bed platform.

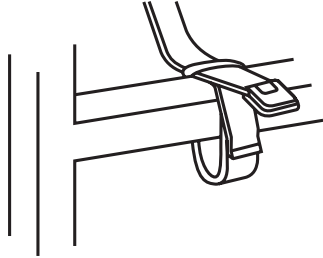

### To Complete the Mattress Installation

Zip the protective cover over the mattress. Ensure that the Huntleigh logo is uppermost and at the foot end of the overlay.

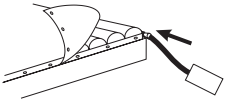

Ensure that the CPR stopper at the head end is securely inserted.

Ensure that the CPR stopper and power cord are clear of profiling (moving) bed mechanisms or other possible entrapment areas. The CPR must be accessible at all times.

### Installing the Pump:

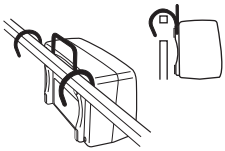

Position the pump feet down on any convenient horizontal surface or alternatively suspend from the bed foot rail by means of swing out hooks.

Connect the male and female air feed tubes into the appropriate outlets on the pump unit. Push connectors in until they click. Ensure that the MR air feed tubes are not "kinked" or twisted.

Insert the mains power plug into a suitable mains power socket.

### SAFETY SIDES

Regarding the use of safety sides, always refer to your local trust policy AND the product user manual.

## Quick Start:

When the **Alpha Relief** pump is switched on at the mains supply, the pump will run a self diagnostic check for approximately 2 seconds during which all indicators will be illuminated. The yellow **Wait** indicator will remain illuminated while the mattress inflates.



Press the **Run/Standby** button on the control panel of the pump.

Allow approximately 25 minutes for the mattress to inflate fully. Once the mattress is fully inflated the yellow **Wait** indicator will extinguish.

Place a bed sheet over the mattress and tuck in loosely.

Once the patient is on the mattress, adjust the cell pressures using the manual pressure adjustment dial to match the patient's weight. If the patient is sat up in bed, add 40kg to the weight setting.

### CPR Control

#### IN THE EVENT OF CARDIAC ARREST

In the event of a patient suffering cardiac arrest and CPR needing to be administered:

#### To Activate CPR:

Pull the CPR tag firmly at the head end of the mattress and disconnect the tube set connectors at the pump.

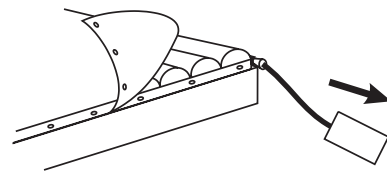

#### To Reset CPR:

Replace the stopper securely and reconnect the air tubes to the pump

